

IZOTHERM

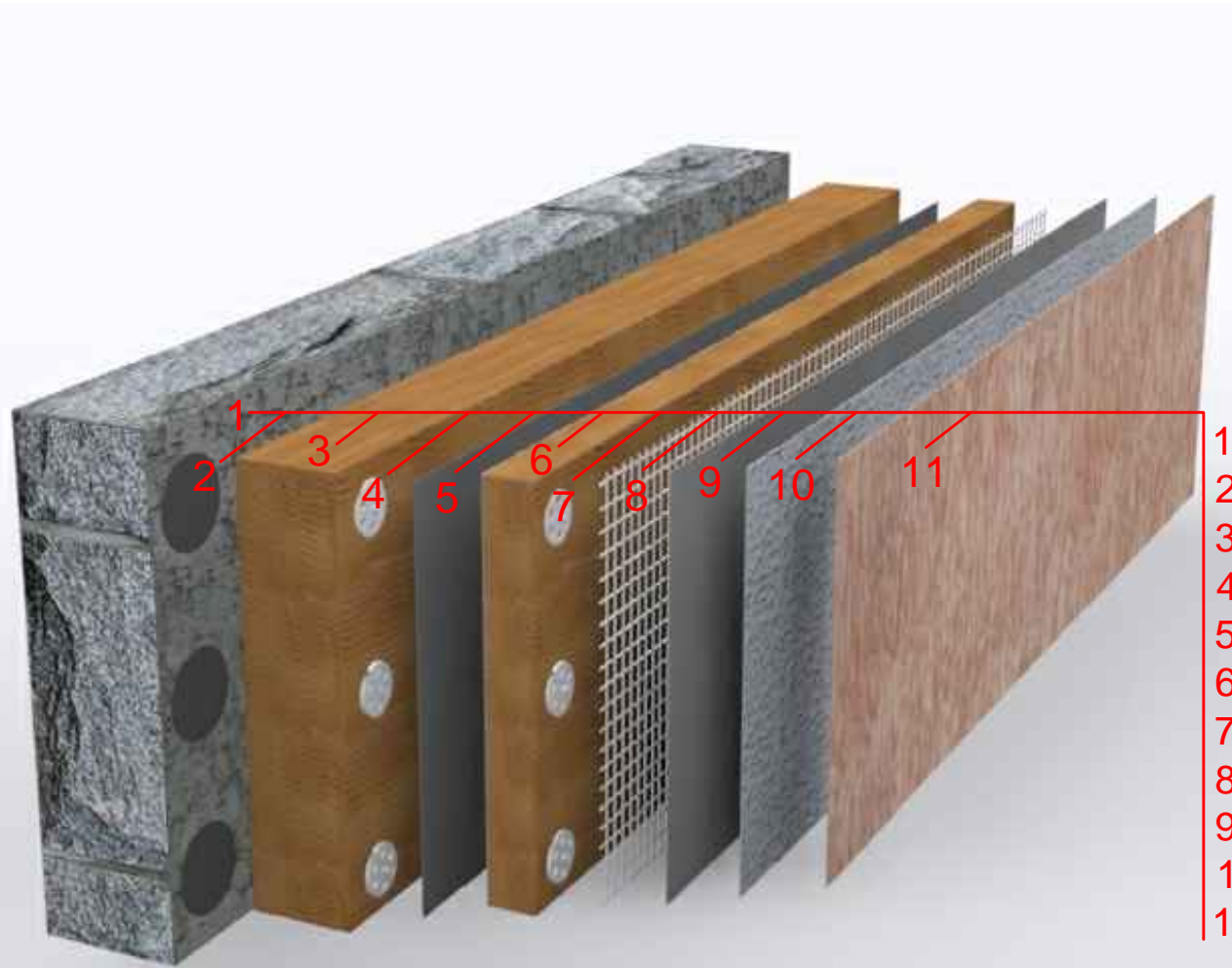

- 1 Wall
- 2 Plastofix adhesive
- 3 Mineralwool 100-175 kg/m3
- 4 Dowell 160mm Ø10
- 5 Plastoren plaster
- 6 Mineralwool 50-175 kg/m3
- 7 Dowell 160mm Ø10
- 8 Facade mesh 160 kg/m2
- 9 Plastoren plaster
- 10 Plastomin decorative top coat
- 11 Paint

инв.№подл.	подпись и дата	взам.инв.№
------------	----------------	------------

"IZOTHERM" LLP		<i>Multitherm</i> ® Insulation System The component of the external insulation system
Project:		
Customer:		
Completed:		

